

Efficient manhole and pipe production:

- Up to DN 2,000mm
- High product output
- Extremely short cycle times



## BFS Atlantic

The ATLANTIC produces premium-quality concrete products. With its extremely short cycle times, the two carriage system for direct demoulding ensures high product output.

Efficient manhole and pipe production – the ATLANTIC spectrum of product ranges from DN 300 to DN 2,000 with product heights from 100 to 2,500 millimeters – in premium quality and with a high output. The model versions range up to fully automatic production.

Range

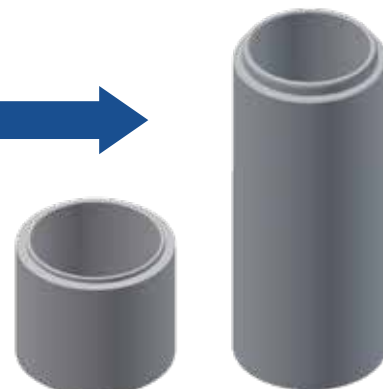

Cycle times starting from 45 seconds! With its extremely short cycle times, the two carriage system for direct demoulding ensures high product output.

Cycle times



The quality and condition of the product is the task of the BFS machine. The consistently high product quality therefore does not depend on the operator's personal qualifications.

Product quality



The BFS-Atlantic system can be operated by a single person, including mounting parts, intermediate storage, and removal.

1-man operation



BFS machines are modular! The system – for single or double production – requires little space and can be tailored to the local circumstances.

Modular





## System Benefits

1. From the base pallet magazine, the pusher system moves one pallet to the release agent spraying station and next into the concrete casting position.
2. The generously dimensioned hydraulic aggregate with state-of-the-art proportional valve technology ensures output reserves, operational reliability, and fast cycle times. The clear structure of the modules enables simple, quick maintenance.
3. Concrete compaction is effected by a modern central vibrator with hydraulic mould core clamping. The frequency-controlled direct drive is realized by dynamic electric motors with a large RPM range. The BFS-typical vibration cross with sophisticated vibration insulation against the foundation, ensures maximum application of vibration forces to the mould equipment with minimum noise.
4. For manhole risers and cones, stepping elements can be vibrated in during production. The mounting

parts can be fed automatically by a robot or manually. Whether steel steps or stirrups in direct cast-in or pre-piercing systems for later insertion – BFS has the right system.

5. After demoulding, the products are automatically evacuated from the production machine. Further transport to the curing area can be done by a computer-controlled ROBOTRAC system or the agile BFS electric trolley.
6. The “Heimo” automatic height monitoring system reliably minimizes dimensional tolerances.

7. After demolding, the products are automatically transported out of the production machine for curing with a computer-operated ROBOTRAC system or ...

8. ... by the agile BFS electric trolley.

### BFS ATLANTIC

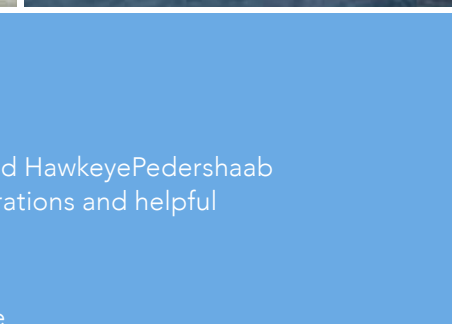
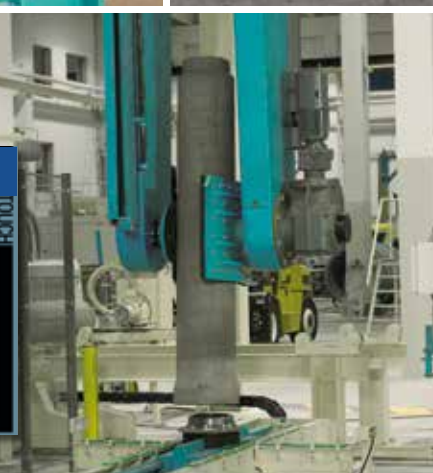
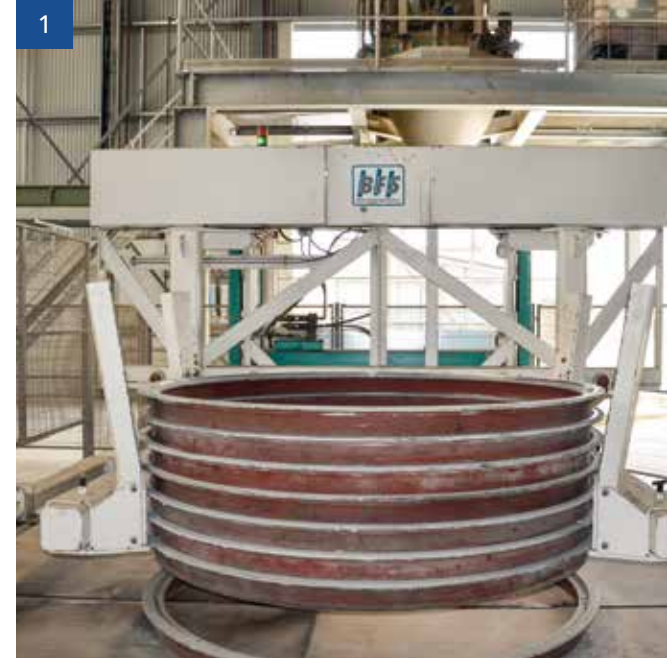

## Our Service Saves Time and Money

Afinitas brings together the engineering strengths and technical expertise of the trusted HawkeyePedershaab and BFS teams. Our global reach and depth of knowledge assures disruption-free operations and helpful advice on how to achieve optimal, efficient results.

Phone +49 7344 960355 | email: [bfs.service@afinitas.com](mailto:bfs.service@afinitas.com) | SKYPE: BFS-customer.service



## Automated Production

### 1. Stepping elements insertion system

- Manually via simple stair access
- Via convenient insertion lift
- Or fully automatic by the BFS insertion robot

### 2. Fully automatic production with turn over moulds

With the additional ATLANTIC ROTO equipment, your ATLANTIC can be transformed into a turn over automat. Manhole base elements, cover slabs, gutters, highway barriers... no problem for the ROTO!

### 3. Transport anchor insertion systems

Semi or fully automatic insertion and cast in of transport anchors, threaded sleeves etc. By proven, reliable BFS technology.

### 4. ROBOTRAC

The fully automatic crane robot for the complete automation of your system. ROBOTRAC assumes the task of transporting fresh products, installation and removal of the spigot-end set rings, and the evacuation of the cured concrete products – quick, reliable, and safe.

### 5. Reinforcement insertion system

For automatic insertion of reinforcement rings or reinforcement cages, the right insertion system is available for both pipe and manhole element production.

### 6. Base pallet handling

The feeding and returning of base pallets from the storage area to the machine, the installation of seals on the base pallets as well as application of release agent are all assumed by the handling systems from the BFS product range.

### 7. Base pallet cleaning

Gentle and fast – pallet ring cleaning is realized by the CNC-controlled PUMA cleaning robot or by the pallet brush machine, which is easy to integrate into the machinery circulation.

### 8. Single or double production:

Atlantic mono or Atlantic duo. With the duo, two products can be produced simultaneously up to DN 600.

### 9. BFS FINITEC technology

During curing, the spigot-end ring remains on the concrete products, resulting in a high dimensional accuracy and roundness of the spigot-end profile. The right system for ideal product quality.

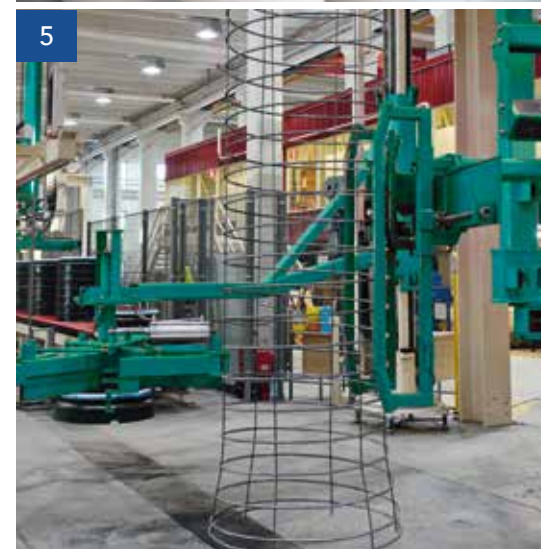

a) Synthetic support rings  
b) Finitec technology







## BFS Atlantic Machine Series

Equipment & Automation  
BFS | HawkeyePedershaab



Forming Systems  
New Hampton | Spillman

Concrete Accessories  
CAM | HawkeyePedershaab | Spillman



Intelligent Infrastructure Solutions  
Visit [www.afinitas.com](http://www.afinitas.com) to learn more.

### Afinitas Equipment and Automation Division

#### North America

Afinitas  
506 S. Wapello St.  
Mediapolis, Iowa 52637  
Phone: +1 319-394-3197  
[info@afinitas.com](mailto:info@afinitas.com)

Parts  
Phone: +1 319-394-2240  
[hawkeyeparts@afinitas.com](mailto:hawkeyeparts@afinitas.com)

Service  
Phone: +1 319-394-2270  
[hawkeyetech@afinitas.com](mailto:hawkeyetech@afinitas.com)

#### Denmark

Afinitas A/S  
Saltumvej 25  
9700 Brønderslev, Denmark  
Phone: +45 9645 4000  
[info-DK@afinitas.com](mailto:info-DK@afinitas.com)

Parts  
Phone: +45 9645 4172  
[aftersales@afinitas.com](mailto:aftersales@afinitas.com)

Service  
Phone: +45 9645 4050  
[pedershaabtech@afinitas.com](mailto:pedershaabtech@afinitas.com)

#### Germany

Afinitas GmbH  
Dr. -Georg-Spohn-Str. 31  
89143 Blaubeuren, Germany  
Phone: +49 7344 96030  
[info-DE@afinitas.com](mailto:info-DE@afinitas.com)

Parts  
Phone: +49 7344 9603-77  
[bfs.spareparts@afinitas.com](mailto:bfs.spareparts@afinitas.com)

Service  
Phone: +49 7344 9603-55  
[bfs.service@afinitas.com](mailto:bfs.service@afinitas.com)

#### Italy

Afinitas srl  
Viale Venezia 79/G  
33074 Fontanafredda, Italy  
Phone: +39 0434 599211  
[info-ITA@afinitas.com](mailto:info-ITA@afinitas.com)

Parts  
Phone: +39 0434 599211  
[info-ITA@afinitas.com](mailto:info-ITA@afinitas.com)

Service  
Phone: +39 0434 599211  
[info-ITA@afinitas.com](mailto:info-ITA@afinitas.com)



Intelligent  
Infrastructure  
Solutions

Afinitas is a global, comprehensive and customer-oriented infrastructure equipment and services platform that brings together the expertise of HawkeyePedershaab, BFS, New Hampton Metal Fabrication, Spillman, and CAM Products.

Headquarters: 8040 Forsyth Blvd. | St. Louis, MO 63105 USA | +1 314-726-2178 | [info@afinitas.com](mailto:info@afinitas.com)