

Utility Anchor

The Utility Anchor is a versatile and economical insert for the lifting and handling of precast concrete elements. The ease of installation and high safe working load are a few of the many benefits of this insert.

Utility Anchors are commonly used for stripping precast elements from forms, loading and handling of elements pre and post shipment, and as a pulling iron on site. The Utility Anchor accepts a standard hook or shackle.

Proper installation is crucial for the product to provide the published safe working loads. The Utility Anchor utilizes reusable rubber recess formers to assist with proper positioning during installation. Safe engagement of the anchor requires that the hook or shackle does not contact the surrounding concrete when loaded and the hook latch should be oriented opposite from the direction of the load.

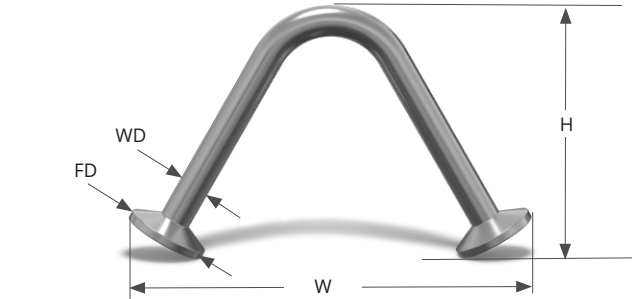

PL54G



PL66G

Foot Markings



Anchor ID

Standard .444" & .671" Utility Anchors

Item #	Panel Size	W	H	FD	WD	Weight (lbs)	Recess Former	Safety Factor	AC 90T (lbs)	AC 90S (lbs)	Anchor ID
.444" Utility Anchor											
PL44G	4"	5 1/4	3 1/8	15/16	.444"	.41	PLRM444	4:1	3200	5800	4/4
PL54G	5"	6	3 3/4	15/16	.444"	.46	PLRM444	4:1	3860	7710	5/4
PL64G	6"	7 3/16	4 3/4	15/16	.444"	.58	PLRM444	4:1	4460	9460	6/4
.671" Utility Anchor											
PL56G	5"	6 3/8	3 3/4	1 5/8	.671"	1.08	PLRM671	4:1	4560	8430	5/6
PL66G	6"	7 9/16	4 3/4	1 5/8	.671"	1.29	PLRM671	4:1	7320	15780	6/6
PL86G	8"	9 7/8	6 3/4	1 5/8	.671"	1.75	PLRM671	4:1	10830	18850	8/6

Material High Strength Steel
Finish HDG

AC 90T (lbs)
AC 90S (lbs)

Anchor Capacity at 90° Tension (lbs)
Anchor Capacity at 90° Shear (lbs)

Minimum compressive strength of normal weight concrete at time of lift = 4000 psi
Anchor capacities based on mechanical testing and industry data